

# STAX | LYFE

## SUITE - 2C

2 BED | 2 BATH | 910 sq.ft.

FLOORS: 3 & 4

KITCHEN

11'4" X 9'3"

LIVING/DINING

10'6" X 21'2"

BALCONY

8'3" X 5'5"

BALCONY

8'3" X 5'5"

PRIMARY BEDROOM

9'2" X 11'1"

BEDROOM 2

8'9" X 10'2"



GROSS SUITE AREA  
(BASED ON TARION STANDARD)

84.5 sq.m      910 sq.ft.

BALCONY AREA

8.6 sq.m      92.6 sq.ft.

TOTAL UNITS PER BLDG = 4

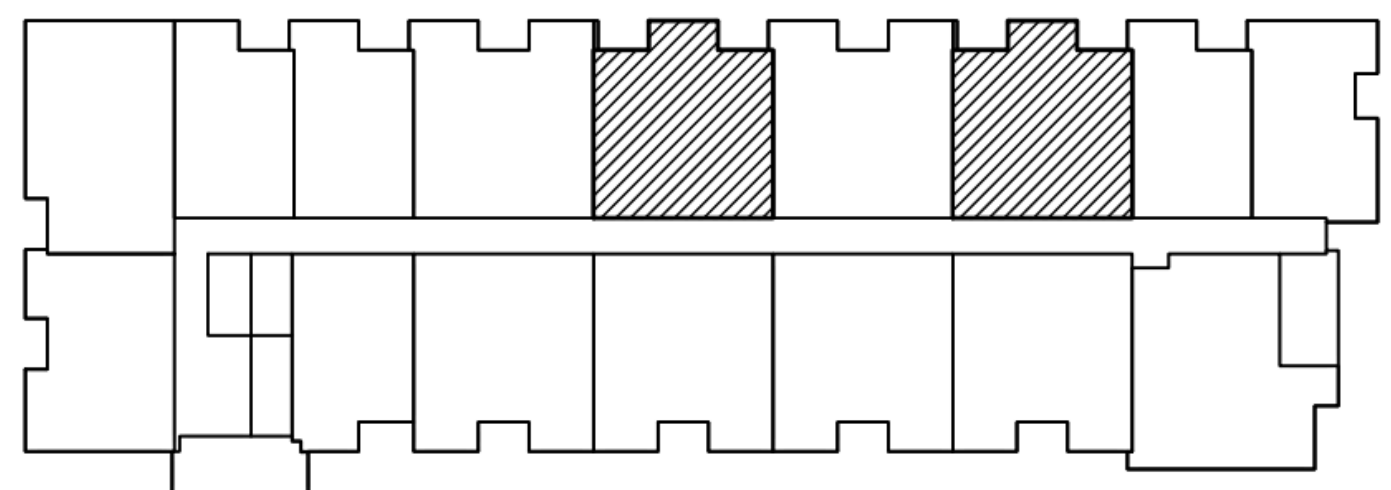

KEY PLAN - 3RD & 4TH FLOORS