

# STAX | LYFE

## SUITE - 2D

2 BED | 2 BATH | 805 sq.ft.

FLOORS: 2,3,4 & 5

KITCHEN/DINING

13'10" X 11'6"

LIVING

14'7" X 10'3"

BALCONY

4'3" X 8'5"

PRIMARY BEDROOM

12'2" X 9'4"

BEDROOM 2

9'3" X 9'11"

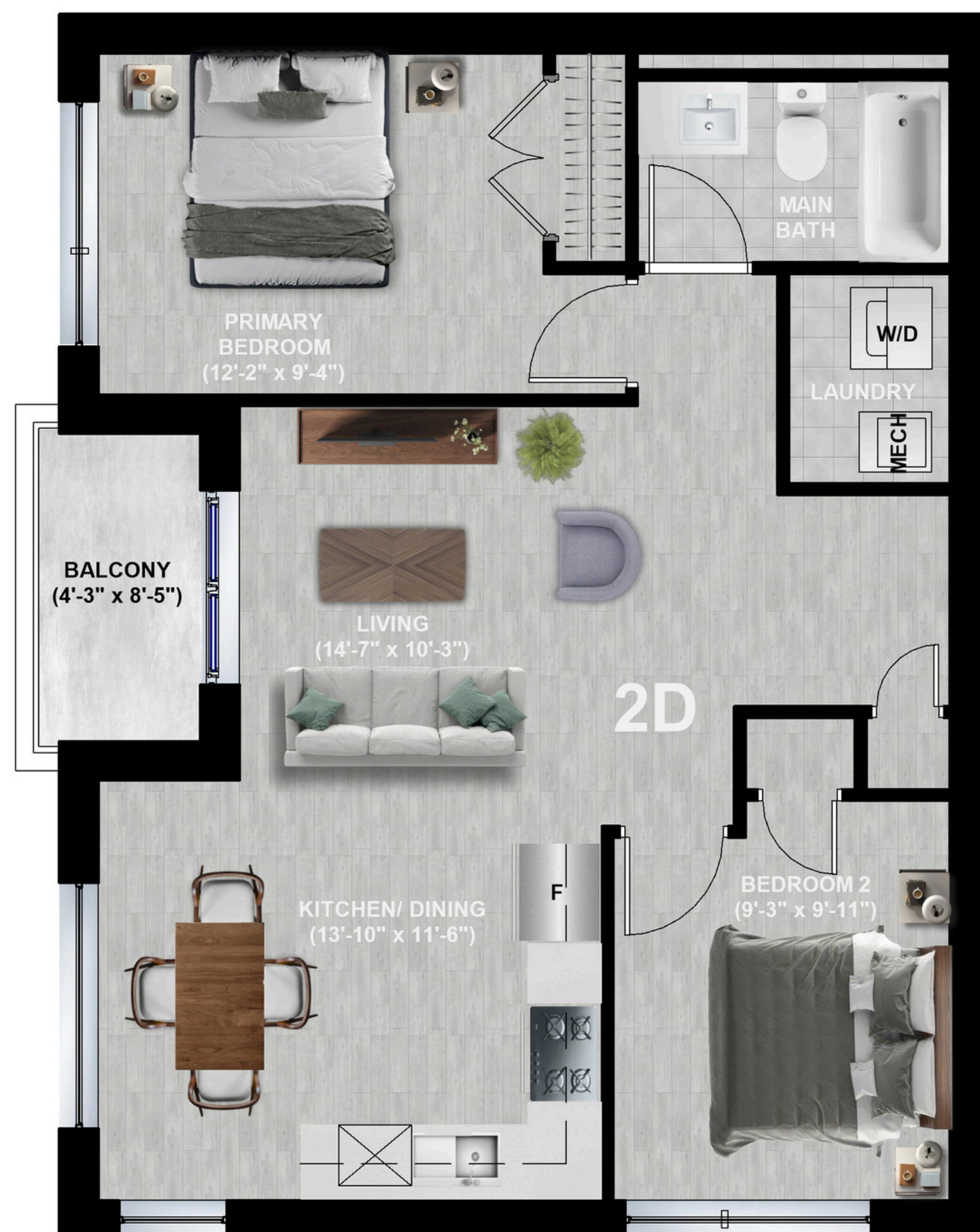

GROSS SUITE AREA  
(BASED ON TARIION STANDARD)

74.8 sq.m      805 sq.ft.

BALCONY AREA

3.4 sq.m      36.2 sq.ft.

TOTAL UNITS PER BLDG = 3

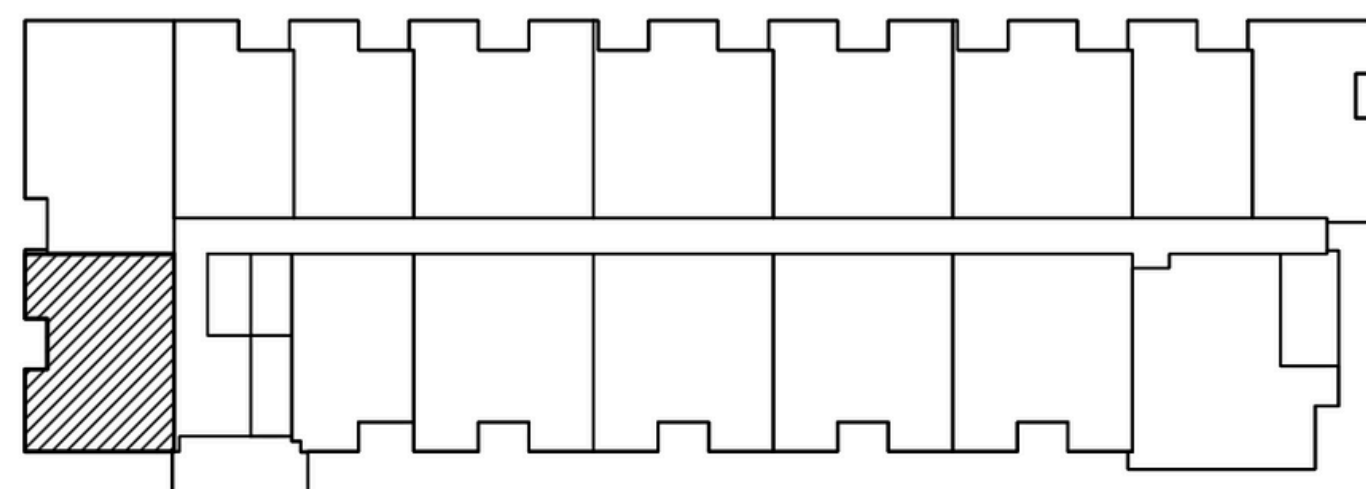

KEY PLAN - 3RD, 4TH, 5TH FLOORS